

# CONNECTOR PINS - THROUGH BOARD

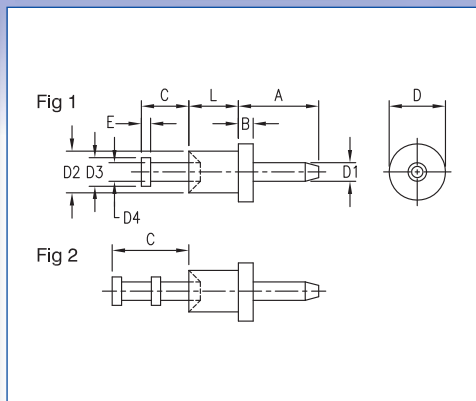

Dimensions in inches (mm)  
See page 94 for recommended Anvil and Punch

How to order code

**460 - XXXX - XX - XX - 00**

Basic Part No.

Finish

Material Code Table		
Component	Material	RoHS
Pin	Brass	✓

Finish Code Table		
Dash No.	Pin Finish	RoHS
-03	Gold over Nickel	✓
-04	Electro-Tin	✓

Fig.	Basic Part No.	L	Board Thickness	A	B	C	D	D1	D2	D3	D4	E	Mtg. Hole Diameter
1	460-3202 -01	.051 (1.30)	.031 (0.79)	.157 (3.99)	.032 (.081)	.076 (1.93)	.078 (1.98)	.025 (0.64)	.058 (1.47)	.033 (0.84)	.020 (0.51)	.015 (0.38)	.061 (1.57)
	-02	.082 (2.08)	.061 (1.57)										
	-03	.113 (2.87)	.094 (2.39)										
	460-5243 -01	.051 (1.30)	.031 (0.79)	.172 (4.37)	.022 (0.56)	.125 (3.18)	.094 (2.39)	.040 (1.02)	.072 (1.83)	.050 (1.27)	.040 (1.02)	.020 (0.51)	.076 (1.93)
	-02	.081 (2.08)	.061 (1.57)										
	-03	.113 (2.87)	.094 (2.39)										
	-04	.145 (3.68)	.125 (3.18)										
	460-3205 -02	.082 (2.08)	.061 (1.57)	0.22 (5.59)	.032 (0.81)	.082 (2.08)	.125 (3.18)	.062 (1.57)	.090 (2.29)	.060 (1.52)	.040 (1.02)	.020 (0.51)	.094 (2.39)
-03	.113 (2.87)	.094 (2.39)											
2	460-2605 -02	.105 (2.67)	.061 (1.57)	.410 (10.40)	.035 (0.89)	.172 (4.37)	.156 (3.96)	.080 (2.03)	.116 (2.95)	.088 (2.24)	.050 (1.27)	.020 (0.51)	.120 (3.05)
	-03	.135 (3.43)	.094 (2.39)										
	-04	.165 (4.19)	.125 (3.18)										

## Typical application

